



CITY OF MERCED

REQUEST FOR PROPOSALS

Fahrens Park Playground Equipment Replacement

The City of Merced (City), Engineering Department, is seeking proposals from playground equipment companies to supply and install new playground equipment and a rubberized surface in the play area at the existing Fahrens Park, located at the southwest corner of Buena Vista Drive and R Street, in Merced, California.

The bidder is required to abide by all applicable provisions of the Labor Code, including payment of the minimum prevailing wage rate as determined by the State Department of Industrial Relations (DIR). No contractor or subcontractor may be listed on a proposal or be awarded a contract for public work unless registered with the DIR pursuant to the Labor Code. This project is subject to compliance monitoring and enforcement by the DIR.

You are hereby invited to submit a proposal based upon the requirements and conditions set forth in this RFP.

PROPOSAL SUBMISSION

Five (5) copies of the completed proposal must be submitted no later than 2:00 p.m. on **Friday, October 15, 2021**. Proposals may be submitted by U.S. Mail, or delivered in person to the City of Merced Engineering Department at the address noted below; post-marks will not be accepted.

Hard copy samples outlined in this RFP shall be sent under separate cover to Michael Beltran, PE, to be received no later than **Friday, October 15, 2021**. The physical samples shall be delivered to the following location:

City of Merced
Engineering Department
Attn: Michael Beltran, PE
678 W. 18th Street
Merced, California 95340

SEE PROPOSAL

One (1) copy of a separate Fee Proposal shall be submitted in a separate sealed envelope marked “**Fee Proposal for Fahrens Park Playground Equipment Replacement**”. The fee proposal must include the costs of the play systems equipment, playground surfacing, delivery charges, any discounts, and cost of supervised installation.

INQUIRIES

Questions pertaining to the RFP should be directed in writing, no later than 72 hours prior to proposal submission to:

Michael Beltran, PE, City Engineer, Phone Number (209) 385-6898, beltranm@cityofmerced.org

678 WEST 18TH STREET, MERCED, CA 95340

TABLE OF CONTENTS

Objective	3
Public Record	4
Withdrawal of Proposals	4
Protest Process	4
Proposal Selection.....	5
Evaluation Process.....	5
Special Issues and Requirements	6
Proposal Content.....	7
Proposal Form.....	8
Technical Specifications	12
Section 101, Playground System.....	12
Section 201, Engineered Wood Fiber.....	14
Section 202, Poured in Place Rubber Surface	14

EXHIBITS:

A. Playground Layout

OBJECTIVE

The purpose of this request is to receive comprehensive proposals from playground equipment companies to supply and install new playground equipment and a rubberized surface at the existing Fahrens Park, located at the southwest corner of Buena Vista Drive and R Street, in Merced, California. Included in the awarded contract will be the complete demolition of the current playground structure including haul off and installation of the new proposed play equipment product and the new playground surfacing, additionally all project closeout, cleanup, and corrective work. The City of Merced will select one supplier to provide equipment and materials for the playground as outlined in this request.

All play equipment shall be manufactured by PlayCraft, Superior, Percussion Play or approved equal.

The approximate playground area is 5,350 square feet. Respondents are responsible for verifying final quantities. The selected Playground Company will be required to adequately protect the areas outside the playground area such that no damage occurs to areas not included in these project improvements.

The project will generally include the following work:

This project consists of the design, procurement and supervised demolition and haul off of the existing playground structure, installation of a playground system including playground surfacing, removal and replacement of a 2" galvanized rail, removal and installation of park benches, installation of new park picnic tables, irrigation work.

The City of Merced requires suppliers to design a playground system that meets or exceeds all current federal standards and shall meet the following certifications, guidelines, rules and regulations:

- a. ADA (Americans with Disabilities Act).
- b. CPSC (U.S. Consumer Product Safety Commission).
- c. ASTM – F1487 (American Society for Testing and Materials standard for Public Use Playground Equipment). The most recent edition.
- d. IPEMA Certification (Internal Play Equipment Manufacturers Association).

Playground structure(s) shall be designed for age groups 2-5 years and 5-12 years.

Also required are detailed technical installation instructions and maintenance and operations manuals from the manufacturer.

Designs submitted for review shall include a full color elevation from all sides and a playground layout visible from overhead.

Color options must be provided.

Catalog/cut sheet information must be included.

Full warranty information including fade resistance must be included.

The available footprint for new playground must meet existing footprint at the park as indicated in Exhibit A.

The project area shall not extend beyond the existing playground fall zones as indicated in Exhibit A.

The Playground Company shall be responsible for walking the project site if deemed necessary prior to submitting a proposal to ensure they have an accurate understanding of the existing conditions and the scope of the project.

PUBLIC RECORD

Responses to this RFP become the exclusive property of the City of Merced. At such time as the Engineering Department recommends a firm to the City Council, all proposals received in response to this RFP becomes a matter of public record and shall be regarded as public records, with the exception of those elements in each proposal which are defined by the Proposer as business or trade secrets and plainly marked as “Confidential,” “Trade Secret,” or “Proprietary”. The City shall not in any way be liable or responsible for the disclosure of any such proposal or portions thereof, if they are not plainly marked as “Confidential,” “Trade Secret,” or “Proprietary” or if disclosure is required under the Public Records Act. Any proposal which contains language purporting to render all or significant portions of the proposal “Confidential,” “Trade Secret,” or “Proprietary” shall be regarded as non-responsive.

Although the California Public Records Act recognizes that certain confidential trade secret information may be protected from disclosure, the City of Merced may not accept or approve that the information that a Proposer submits is a trade secret. If a request is made for information marked “Confidential,” “Trade Secret,” or “Proprietary,” the City shall provide the Proposer who submitted the information with reasonable notice to allow the Proposer to seek protection from disclosure by a court of competent jurisdiction.

WITHDRAWAL OF PROPOSALS

A Proposer may withdraw its proposal at any time before the expiration of the time for submission of proposals as provided in the RFP by delivering a written request for withdrawal signed by, or on behalf of, the Proposer.

PROTEST PROCESS

A Consultant that submits a proposal that is disqualified may challenge the disqualification by filing a protest within seven (7) calendar days of the date of the City’s notice of disqualification. Staff recommendations to award the agreement(s) to a particular Consultant or Consultants shall be posted on the City’s website. An unsuccessful Consultant may file a protest no later than seven (7) calendar days after the recommendation is posted on the website, except for protests regarding disqualification, which must be protested within seven (7) days of the disqualification notice. All protests shall be in writing, filed with the **City Engineer, Michael Beltran, PE**, and include the following:

- RFP Name;
- The name, address and telephone number of the protester;
- A detailed statement describing the legal and factual grounds for the protest, including copies of relevant documents;
- The form of relief requested; and
- The signature of the protester or its authorized representative.

The City Engineer will render a written decision within 30 days after the protest is filed. The City will not request City Council authorization to award the contract until the protest process is completed.

PROPOSAL SELECTION

This RFP does not commit the City to enter into a contract, nor does it obligate the City to pay for any costs incurred in preparation and submission of proposals or in anticipation of a contract. The City reserves the right, without qualification, to:

- Select any proposal when such action is considered to be in the best interest of the City;
- Reject any and all proposals;
- Issue subsequent Requests for Proposals;
- Postpone opening for its own convenience;
- Approve or disapprove the use of particular subcontractors;
- Accept other than the lowest offer;
- Exercise discretion and apply its judgment with respect to selection of any proposals submitted;
- Waive informalities and irregularities in the Proposals;
- Negotiate with any, all or none of the Proposers;
- Select proposals, based on initial proposals received, without discussion or after detailed discussions or contract negotiations;
- Enter into an agreement with another Proposer in the event the originally selected Proposer defaults or fails to execute an agreement with the City.

An agreement shall not be binding or valid with the City unless and until it is executed by authorized representatives of the City and of the Proposer.

This RFP is not a request for bids or an offer by the City to contract with any party responding to this RFP. In addition, no reimbursement for expenses incurred or time spent will be made. All submittals and information contained therein provided in the proposal package shall become the property of the City.

Please provide detailed information for each item in the Playground Selection Criteria table which is included in the Proposal Form. The City may base its selection on those criteria, as well as the following relevant criteria:

- 1) Price (in a separate sealed envelope)
- 2) Corporate Financials
- 3) Materials Proposed
- 4) Experience
 - a) With proposed product
 - b) Crew Installation
 - c) Local Installations
- 5) Warranty
- 6) Customer Service
- 7) Other criteria deemed pertinent by the City

EVALUATION PROCESS

Proposals will be evaluated by a selection committee based on the following criteria and corresponding Criteria Points:

1. ADA, ASTM, IPEMA & CPSC compliance Yes/No
2. Proposal addresses design guidelines and specifications 0-25
3. Quality of design, play value, and target demographic 0-20
4. Quality and durability of equipment 0-20
5. Uniqueness of equipment and “Green” materials/construction 0-10
6. Reputation, reliability, and customer service of manufacturer 0-15
7. Overall quality of proposal 0-10

Maximum Point Value: 100

The selection committee will make a recommendation to the City Council for award. The acceptance of the proposal will be evidenced by written Notice of Award from the City’s designated project champion to the successful Proposer.

SPECIAL ISSUES AND REQUIREMENTS

Form and Execution of Contract. The form of contract is Attachment A. It shall be executed and returned with the Consultant’s proposal. If the Consultant is unable to execute the Contract, then the Consultant’s proposal will be deemed incomplete and not considered.

Labor Code. The Consultant shall comply with Sections 3700 et seq. of Labor Code of the State of California, requiring every employer to be insured against liability for worker’s compensation.

The bidder is required to abide by all applicable provisions of the Labor Code, including payment of the minimum prevailing wage rate as determined by the State Department of Industrial Relations (DIR).

Insurance. The Consultant shall also meet the insurance requirements listed in Attachment B, including liability insurance in the amount of \$1,000,000, naming the Agency as additional insured.

Conflict of Interest. The Consultant must be aware of and comply with conflict of interest rules included in the California Political Reform Act, and Section 1090 et. Seq. of the Government Code. The Political Reform Act requires City/Agency officers and committee members to file statements of interest and abide by a Conflict of Interest Code. Section 1090 limits or prohibits a public official from contracting with a body of which an official is a member. Section 1090 applies even where the officer only reviews the contract for the approving body.

PROPOSAL CONTENT

Included in the proposal package shall be the following information:

1. Playground Selection Criteria document, required supporting third party test data, and information requested in the document, including the following:
 - a. List of all complete installed playgrounds with specified product, including those in California. [This list may be limited to the twenty (20) **most recent** completed installations.]
 - b. Proposed Foreman resume, as applicable.
 - c. Company playground warranty for this specific project, including insurer information.
 - d. Corporate financial information.
2. Proposed product and pricing on completed Proposal Form, including California Ordering Instructions and Special Provisions.
3. Proposals must include complete drawings for each design, specifications and pictures for each component in designs and colors available. Proposals must include a bid price for each design presented. Bids must list the cost of the equipment, fall zone material, and labor separately. The City of Merced reserves the right to reject any and all proposals with or without cause, and to accept proposals which it considers most favorable.

Proposal Form

(due no later than 2:00pm on Friday, October 15, 2021)

City of Merced ~ Fahrens Park Playground Equipment Replacement

At the time of the proposal, the following form needs to be filled in and returned with other requested materials. A unit price for the various pieces of equipment shall be used to determine final price. Proposal shall be all inclusive of all product, taxes, delivery, installation, fees, etc. All work shall include new playground installation and new playground surface, and all work shall carry worker's compensation and prevailing wage rates.

DIR Registration. City will not accept Proposals from or enter into any contract with a bidder without proof that the bidder and its Subcontractors are registered with the Department of Industrial Relations to perform public work under Labor Code Section 1725.5, subject to limited legal exceptions.

This project is subject to compliance monitoring and enforcement by the Department of Industrial Relations.

The contract with the Playground Company shall be direct with the City of Merced. Please submit the Prices below in a separate sealed Envelope

Submitted Playground Product Name: _____

Submitted Surfacing Product Name: _____

Proposed Amount of Playground Equipment Product:

(Total price including products, sales taxes, delivery, removal of existing equipment, installation, warranty, and maintenance program):

Unit Price (Lump Sum): \$ _____

Proposed Amount of Playground Surfacing Product:

(Total price including product, sales taxes, delivery, installation, site preparation, warranty, and maintenance program):

	Quantity	Unit	Unit Price	Total Price
Rubberized Surface	3,450	SF		
Fiber Surface	1,900	SF		

Total Price: _____

Proposed Amount of Benches, Tables, and Handrail Product:

(Total price including product, sales taxes, delivery, demolition, site preparation, installation, warranty):

	Quantity	Unit	Unit Price	Total Price
Park Bench	4	EA		
Park Picnic Table	3	EA		
Handrail	124	LF		

Playground Selection Criteria

At time of the proposal, the following form needs to be completely filled in and returned with other requested materials in a separate sealed Envelope. Playground Company shall provide values based on the units shown below and based on ASTM/Standard testing procedures, if applicable.

Property	Model #	Value (Fill in the Blank)	Quantity	Units	ASTM/Standard
<u>Swing Set Area</u>					
Age 2-12 Safety Sign			1	EA	
Engineered Wood Fiber			1,900 Sq. Ft.	LS	
2 Bay Swing Seat Ages 2-12			1	EA	
Other Proposed Playground Equipment List Below:					
<u>5-12 Age Group Area</u>					
Demolition of Existing Play Structures			2	LS	
Remove Existing Play Area Material			3,450 Sq. Ft.	LS	
Age 2-12 Safety Sign			1	EA	
4" Depth EDPM Poured-in-Place Rubber Safety Surfacing			3,450 Sq. Ft.	LS	
Rock Climbing Equipment			1	LS	
Playground Structure			1	LS	
Other Proposed Playground Equipment List Below:					
<u>Misc:</u>					
Park Picnic Table			3	EA	
Park Bench			4	EA	

In addition to the above forms that are to be submitted in a separate sealed envelope, the Playground Company shall provide the following information as part of the proposal package:

1. Contractor shall submit a list identifying the installed playgrounds with similar playground product as identified in its proposal. List of installations submitted and proposed sites, installation shall include project site, location, and current owner contact name and phone number.
2. In addition, playground company shall submit list of completed playground installations in California (of similar specified playground product). All required information noted above shall be provided.
3. Playground Company is to describe their field maintenance and warranty repair capabilities and their approach to this work. This includes the location of crews that can respond to City requests, equipment used, etc.

WARRANTY

At time of proposal submission, the Playground Company shall submit its Manufacturer's Warranty which guarantees the usability and playability of the playground system for its intended uses commencing with the date of Notice of Completion. The warranty submitted must have the following characteristics:

1. Submit Manufacturer Warranty and ensure that forms have been completed in Owner's name and registered with Manufacturer and Insurance Carrier.
2. Insurance carrier must confirm that the policy is in force and premiums paid. The manufacturer's warranty shall include general wear and damage caused from UV degradation.
3. Upon completion of the playground, the playground manufacturer will supply evidence that the policy is in effect, fully funded, and that the installation is added to the policy.
4. Policy must be in force at time of bid. Insurance carrier must confirm that the policy is in force and premiums paid for entire warranty duration in full.
5. Warranty shall have no restrictions on hourly use limitations as long as the primary use on the equipment is as anticipated in the original design.
6. Must be a warranty from a single source covering workmanship and all self- manufactured or procured materials.
7. Guarantee the availability of replacement material for the playground system installed for the full warranty period.
8. The playground company must verify that its onsite representative has inspected the installation and that the work conforms to the Manufacturer's requirements.
9. The warranty shall be made out to the City of Merced.

CORPORATE FINANCIAL INFORMATION

At time of proposal submission, the Playground Company shall submit the following corporate information:

1. Audited Financial Statement.
2. Proof of Liability insurance including the amount of coverage and expiration date. Information shall be provided directly from the Playground Company's insurance company.
3. List of Majority Directors (if privately owned) and Board of Directors.
4. Provide proof of Employment Practices Liability Insurance.

TECHNICAL SPECIFICATIONS

SECTION 101 PLAYGROUND SYSTEM

PART 1 - GENERAL

SUMMARY

Furnish all labor, materials, tools, and equipment necessary to install, in place, all playground equipment, material and concrete base layer including base rock subbase, as indicated on the plans and as specified herein, including components and accessories required for a complete installation, including but not limited to: subgrade preparation, and timely installation: aggregate base course, grading and compacting, any piping and drain components as necessary. The work shall include any incidentals to provide a finished job.

- A. The installation of all new materials shall be performed in strict accordance with the manufacturer's written installation instruction, and in accordance with all approved shop drawings as applicable.

DEFINITIONS

Use Zone: According to ASTM F1487, the "area beneath and immediately adjacent to a play structure or equipment that is designed for unrestricted circulation around the equipment and on whose surface it is predicted that a user would land when falling from or exiting the equipment."

IPEMA: International Play Equipment Manufacturers Association.

Fall Height: According to ASTM F 1487, "the vertical distance between a designated play surface and the protective surfacing beneath it."

DESIGN REQUIREMENTS

Compliance with current guidelines, standards, laws and building codes for safety and accessibility: ASTM F1487-11 – Standard Consumer Safety Performance Specifications for Playgrounds for Public Use. U.S. Consumer Products Safety Commission (CPSC) Guidelines (No. 325) – Handbook for Public Playground Safety ADA Accessibility Guidelines (ADAAG).

Site specificity of design – Equipment design/component selection is based on specific needs of the City of Merced, physical constraints of the site. Design requirements include: Play value; Capacity; Footprint; Color availability; Visual density and appearance; Age appropriateness; Height/Size; Sensory stimulation; Accessibility/usability for those with special needs.

Products selected are durable and proven to withstand very high use environment.

SUBMITTALS

Product Data: For each type of product indicated.

LEED Submittals: Percentage of recycled materials used; percentage of post-consumer recycled materials used.

Shop Drawings: For playground equipment and structures. Include plans, color renderings, elevations, and installation details.

Samples: Provide color charts. Provide material samples upon request or as required.

Qualifications: For qualified installer, manufacturer, and testing agency.

Test Reports: Provide evidence of IPEMA certification for playground products.

Certifications:

- IPEMA (International Play Equipment Manufacturers Association) third party certification for conformance to ASTM F1487.
- Statement from manufacturer that products meet current safety and accessibility requirements.
- Any other applicable certifications.

Closeout Submittals:

Maintenance Kit: An order-specific maintenance kit shall be provided for each structure order. The kit will include a notebook or packet with a second set of installation documents and order-specific maintenance documentation with recommendations on how often to inspect, what to look for, and what to do to keep the equipment in like-new condition. The kit also includes touch-up primer, appropriate color touch-up paint, sandpaper, appropriate color touch-up PVC, graffiti remover and additional installation tools for the tamperproof fasteners.

Warranty Information:

Statement from manufacturer's representative identifying that installation has been performed in accordance with installation instructions.

QUALITY ASSURANCE

Manufacturer Qualifications:

- Standard products are IPEMA (International Play Equipment Manufacturers Association) third party certified for conformance to ASTM F1487.

Installer Qualifications: The Contractor installing the equipment must be experienced in the installation of play equipment with personnel, facilities, and equipment adequate for the work specified and shall, within 48 hours of a request, produce written proof of such.

Sample Installations: Contractor shall upon request produce a list of at least 20 other projects where similar work, from same manufacturer, has been performed and could be reviewed.

Pre-installation Conference: Conduct conference at Project site prior to the start of the playground equipment installation work, coordinate a conference at the Site to review the construction schedule, availability of materials, installers personnel qualifications, equipment and facilities needed to make progress and avoid delays, installation procedures, testing, inspecting, and certification procedures, and coordination with other work. Meeting shall include the Contractor, City's Representative, installer, and any other subcontractors or material technical service representatives whose work, or products, must be coordinated with the playground equipment installation work.

SECTION 201
PLAYGROUND SURFACING SPECIFICATIONS
ENGINEERED WOOD FIBER

Engineered wood fiber (EWF) shall meet the standard specifications for EWF in ASTM F2075 and comply with all applicable safety and ADA requirements. Contractor shall provide a copy of ASTM F1292 testing from the EWF manufacturer prior to placement. EWF shall meet accessibility guidelines for firmness and stability based on ASTM F1951. Any existing EWF material at the site still in acceptable condition shall be relocated and leveled outside of the playground equipment use zones. After construction ensure that ground is level and graded toward existing drainage prior to placing new EWF. Place new EWF material in uniform, level manner around playground equipment use zones to a depth that ensures impact attenuation for the fall height value appropriate for the highest accessible part of the equipment.

SECTION 202
PLAYGROUND SURFACING SPECIFICATIONS
POURED-IN-PLACE RUBBER SURFACE

PART 1 – General

1.01 POURED-IN-PLACE RUBBER PLAYGROUND SURFACING

- A. Playground Surfacing is a 2-layer, seamless system comprised of a base layer of 100% post-consumer recycled SBR rubber & polyurethane binder and a top layer of EPDM rubber and polyurethane binder. The porous system is field-applied in any configuration and dimension to achieve required fall heights. Shall be IPEMA certified. Poured-in-place rubber shall be Playpour or approved equal.

1.02 SAFETY AND TESTING

- A. ASTM D412 Standard Test Methods for Vulcanized Rubber and Thermoplastic Rubbers and Thermoplastic Elastomers-Tension.
- B. ASTM D624 Standard Test Method for Tear Strength of Conventional Vulcanized Rubber and Thermoplastic Elastomers.
- C. ASTM D2047 Standard Test Method for Static Coefficient of Friction of Polish-Coated Floor Surfaces as Measured by the James Machine.
- D. ASTM D2859 Standard Test Method for Flammability of Finished Textile Floor Covering Materials.
- E. ASTM E303 Standard Test Method for Measuring Surface Frictional Properties Using the British Pendulum Tester.
- F. ASTM F1951 Standard Specification for Determination of Accessibility of Surface Systems Under and Around Playground Equipment.

1.03 PERFORMANCE REQUIREMENTS

- A. Flammability (ASTM D2859): Pass.
- B. Tensile Strength (ASTM D412): 60 psi (413 kPa).
- C. Tear Resistance (ASTM D624): 140%.
- D. Water Permeability: 0.4 gal/yd²/second.
- E. Accessibility: Comply with requirements of ASTM F1951.
- F. Dry Static Coefficient of Friction (ASTM D2047): 1.0.
- G. Wet Static Coefficient of Friction (ASTM D2047): 0.9.
- H. Dry Skid Resistance (ASTM E303): 89.
- I. Wet Skid Resistance (ASTM E303): 57.

1.04 SUBMITTALS

- A. General: Submit all applicable submittals.
- B. Product Data: Submit manufacturer's product data and installation instructions.
- C. Verification Samples: Submit manufacturer's standard verification samples of 9" x 9" minimum.
- D. Quality Assurance/Control Submittals: Submit the following:
 - 1. Certificate of qualifications of the surfacing installer.
- E. Closeout Submittals: Submit the following:
 - 1. Warranty documents specified herein.

1.05 QUALITY ASSURANCE

- A. Utilize an installer trained and approved by the manufacturer, having experience with other projects of the scope and scale of the work described in this section.

1.06 DELIVERY & STORAGE

- A. Deliver materials in manufacturer's original, unopened, undamaged containers with identification labels intact.
- B. Store materials protected from exposure to harmful environmental conditions and at a minimum temperature of 40 degrees F and a maximum temperature of 90 degrees F.

1.07 PROJECT SITE CONDITIONS

- A. Install surfacing on a dry sub-surface with no prospect of rain within initial drying period, and within 40 degrees F and 90 degrees F.

1.08 WARRANTY

- A. Playground surface shall maintain required impact attenuation characteristics and be guaranteed against defects in workmanship and materials for a period of no less than five years from date of completion of work. Maintenance requirements must be maintained for duration of warranty period.

PART 2 – Products

- A. Playground surface shall consist of synthetic materials meeting the requirements of this specification. Playpour™ components shall be manufactured by ECORE International™ and the system installed by a certified installer.

2.01 BASE LAYER

- A. Playpour Primer: Polyurethane.
- B. Playpour Poured In Place Base: Blend (86% rubber & 14% polyurethane) of strand and granular 100% recycled SBR (styrene butadiene rubber) and polyurethane. Depending on ASTM F1292 requirements for critical fall height 9 feet, select base layer thickness of 4.0 inches.
- C. Color: 50/50 Beige and Black color blend.

2.02 TOP LAYER

- A. Playpour Primer: Polyurethane.
- B. Playpour Poured In Place Top: Blend (82% rubber & 18% polyurethane) of recycled EPDM (ethylene propylene diene monomer) and polyurethane. Nominal thickness of 0.5", with a minimum 0.325" and a maximum 0.625".
- C. Colors: Terra Cotta Red, Primary Red, Orange (indoor only), Pink, Gold, **Beige**, Yellow, Bright Green, Army Green, Hunter Green, Teal, Sky Blue, Royal Blue, Purple, Pearl, Eggshell, Brown, Light Gray, Dark Gray, Black. Custom color shall be a 50/50 Beige and Black color blend.

PART 3 – Execution

- A. Comply with the instructions and recommendations of the surfacing manufacturer.

3.01 EXAMINATION

- A. Verification of Site Conditions: Verify that substrate conditions are suitable for installation of the poured in place surfacing. Do not proceed with installation until unsuitable conditions are corrected.

- B. Drainage: Proper drainage is critical to the longevity of the Playpour surfacing system. Inadequate drainage will cause premature breakdown of the poured system in affected areas; and void the warranty.

3.02 PREPARATION

- A. Existing Substrate Preparation: Remove any loose or delaminated material that would be deleterious to application of the new surface to a depth of 12 inches below the bottom of the Base Layer. Fill cracks in existing concrete with cementitious patching compound.
- B. Surface Preparation: Using a brush or short nap roller, apply primer to the substrate perimeter and any adjacent vertical barriers (such as playground equipment) at the rate of 300 ft²/gal.

3.03 INSTALLATION

- A. Do not proceed with playground surfacing installation until all applicable site work, including substrate preparation, fencing, playground equipment installation and other relevant work, has been completed.

B. Aggregate Base Installation:

1. Subgrade compaction will not be necessary, but shall be removed to a depth of 12 inches and replaced with 12 inches Caltrans Class 2 Recycled Aggregate Base. The Aggregate base shall be moisture conditioned to at least the optimum moisture content and compacted to at least 90% relative compaction, as determined by ASTM D1557.

C. Base Layer Installation:

1. Using screeds and hand trowels, install the base layer at a consistent density of 29 pounds, 1 ounce per cubic foot to the specified thickness.
2. Allow base layer to cure for sufficient time so that indentations are not left in the base layer from applicator foot traffic or equipment.
3. Do not allow foot traffic or use of the base layer surface until it is sufficiently cured.

- D. Primer Application: Using a brush or short nap roller, apply primer to the base layer perimeter and any adjacent vertical barriers that will contact the surfacing system at the rate of 300 ft²/gal.

E. Top Layer Installation:

1. Using a hand trowel, install top layer at a consistent density of 58 pounds, 9 ounces per cubic foot to a nominal thickness of 0.5".
2. Allow top layer to cure for a minimum of 48 hours.
3. At the end of the minimum curing period, verify that the surface is sufficiently dry and firm to allow foot traffic and use without damage to the surface.
4. Do not allow foot traffic or use of the surface until it is sufficiently cured.

3.04 PROTECTION

- A. Protect the installed surface from damage resulting from subsequent construction activity on the site.

SECTION 203 MISCELLANEOUS SPECIFICATIONS

1.00 PARK BENCHES

- A. Benches shall be 5-foot precast concrete benches and placed on a concrete pad.

2.00 PARK PICNIC TABLES

- A. Picnic tables shall be 6-foot rectangular concrete tables and place on a concrete pad.

3.00 HANDRAIL

- A. Install 1- ½" galvanized steel pipe, with 3/16" welded construction as shown on the plans and as called for in these specifications. All welds shall be smooth

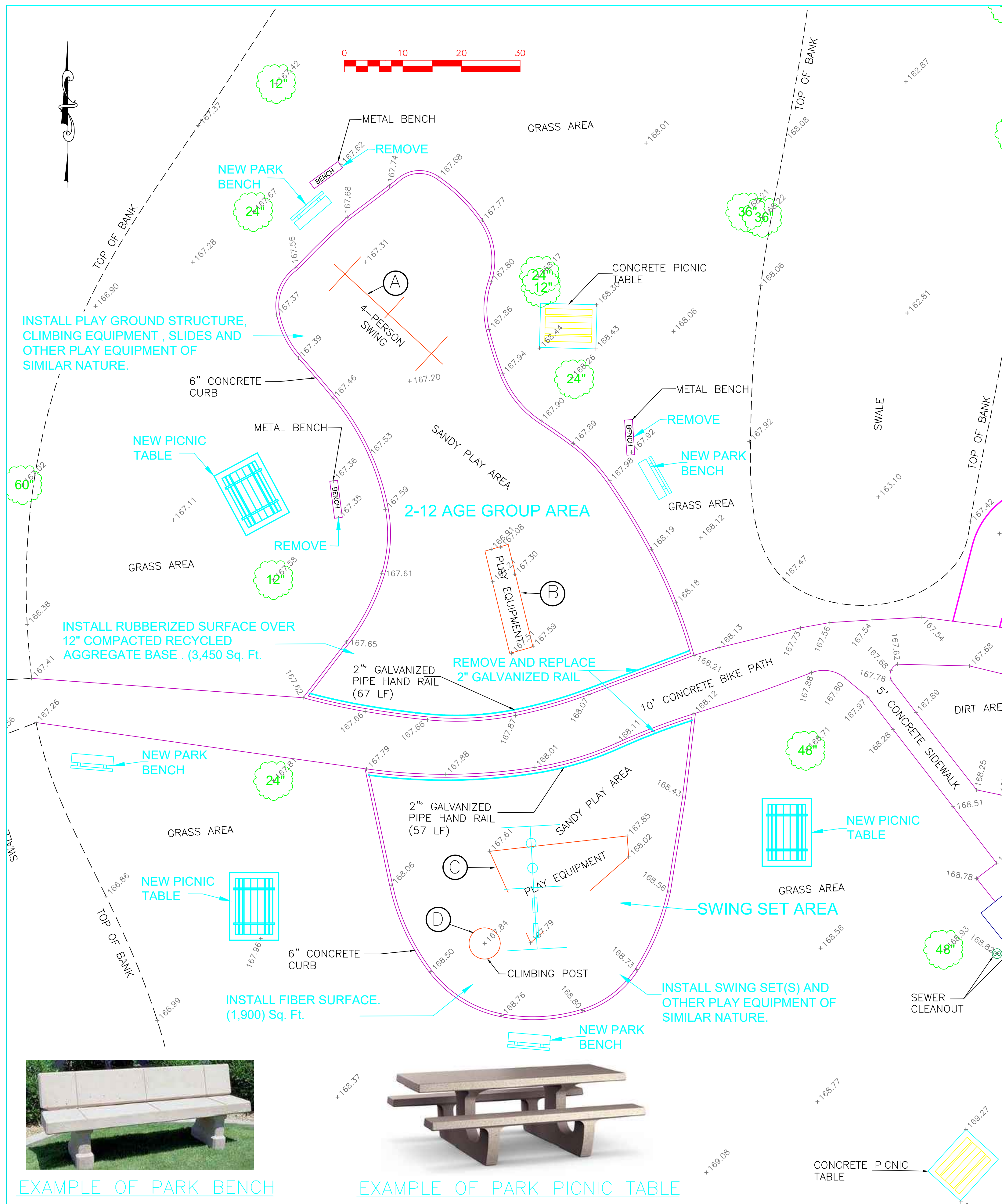

EXAMPLE OF PARK BENCH



EXAMPLE OF PARK PICNIC TABLE



EXISTING PLAY GROUND & EQUIPMENT